

ALUMINIUM SLIDING DOOR

INSTALLATION GUIDE



**BIFOLD
SALES**

PART OF THE **PBSL GROUP**

WELCOME TO OUR SLIDING DOOR INSTALLATION GUIDE



LOW MAINTENANCE



10-YEAR GUARANTEE



1.6W/M2K U VALUE



LOW E TOUGHENED DOUBLE GLAZING



HIGH SECURITY MULTI-POINT LOCKING SYSTEM



Low E Toughened Double Glazing

1.6W/m2K U Value

Quality components
for flawless operation

Ultra-Smooth Sliding

BSEN12150 &
BSEN1279
Compliant

High Security
Multi-Point
Locking System

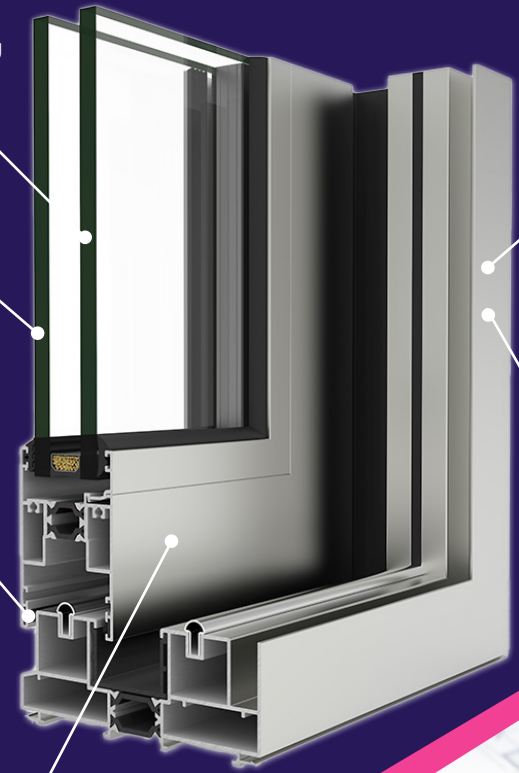

At Bifold Sales we supply a range of aluminium sliding doors, created with innovative technology and engineering to result in a modern appearance and slim sightlines.

KEY POINTS

- 1 Thermally broken minimalist sliding system that provides maximum luminosity with a minimal aluminium interlock profile.
- 2 It has an elegant design, minimal sight-lines
- 3 BSEN12150 & BSEN1279 Compliant

Even a simple patio door replacement can transform your space and give your room a brand-new feel. Our aluminium sliding patio doors provide not only exceptional security, but also an abundance of natural light, so you can enjoy a crystal-clear view of your surroundings.

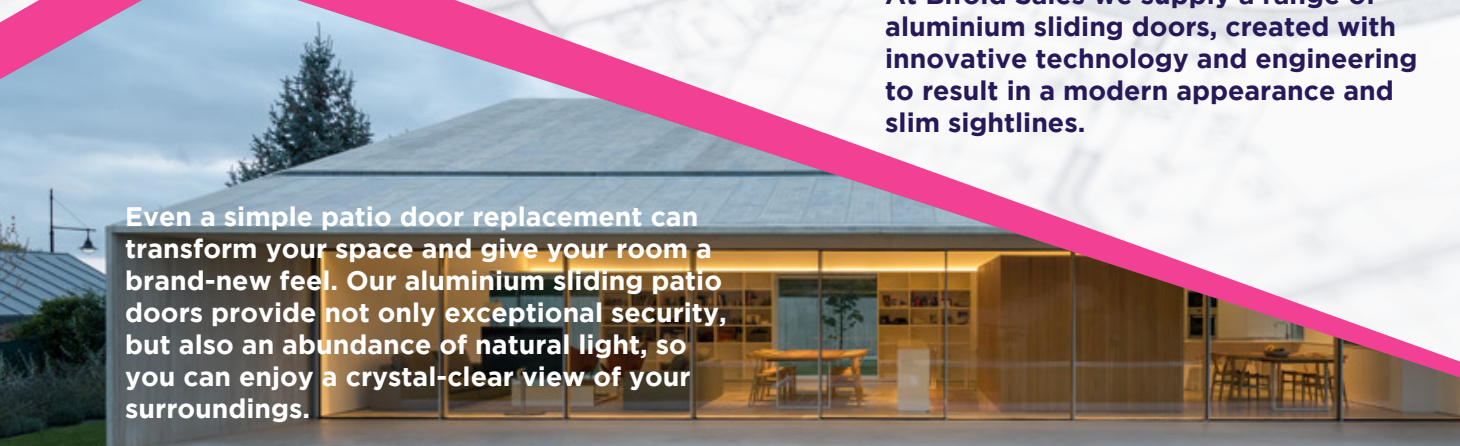

SITE SURVEY



Assess the aperture for suitability:

We recommend a surveyor check for any defects & deficiencies around the structural opening. If any issues are found, then the purchaser should be notified, & an agreement reached as to who is responsible for rectifying these issues prior to the new sliding door being installed.



Measuring the aperture: Generally we recommend three measurements are taken. Width & height in three places, the smallest measurement of width & of height, minus 10mm allowance is used to determine the required frame size. The squareness of the aperture determined by, for example, taking diagonal measurements.



Structural loading requirements: A surveyor should take reasonable steps to check that there is a lintel or other means of supporting the structure above the sliding door. Where no such support exists & the load is supported by any existing fenestration, then alternative means of providing this support must be provided.



Final Checks: We recommend a surveyor should determine whether the sliding doors are suitable for the location they are to be installed. Where any doubts exist, the manufacturer should be consulted.

Important.

All Installations must comply with all elements of BS8213-4 Code of Practice for the survey & installation of windows & external doorsets.

To ensure the correct functioning of the sliding doors, it is imperative that the instructions in this guide are followed, in the correct order.



BEFORE YOU START

- 1** We recommend you do not book any contractors before your Sliding Door is delivered.
- 2** Check the Sliding Door fits the aperture prior to commencing any works.
- 3** All information supplied by the surveyor should be given to your chosen installer.
- 4** Ensure all relevant tools & equipment are available prior to the start of any work.



Tools

Angle Grinder & Drill / Drill Driver
Drill & Driver bits
Tape Measure & Set Square
Stringline & Spirit level
Gasket sheers & Glazing shovel
Sealant gun
Pencil
Mallet

Planning Permission:

Attention must be paid to the legal requirement to identify the need for any planning permission, e.g. for listed buildings or conservation areas.

Risk Assessment:

A risk assessment is advised for the suitability of the sliding door design. The responsibility for this lies with the designer, & it should be carried out by a competent person (commonly the surveyor).

The Property

- 5** Existing fenestration should be removed with care to avoid damage.
- 6** Check there is a lintel or other means of supporting the structure above the sliding door.
- 7** **Bifold Sales** is not responsible for the installation, any damage caused or for removal of any waste from site.

Safety

Personal protection equipment (PPE) should be worn at all times when installing aluminium sliding doors. We recommend to wear gloves, protective eye wear, & a dust mask.





STEP 1 Use a spirit level & a string line to assess the level of the threshold you are working from.

Place packers to level if required. To stop your packers from moving around apply a small blob of sealant to help hold them in place.

Once level, double check that the door will still have enough clearance on height when it is installed.



STEP 2 The sliding door must be supported along its full length. Use a bed of mortar along the full length between the required packers.

- Prepare the aperture by making sure it is clean- remove any old silicone & brush down the threshold.

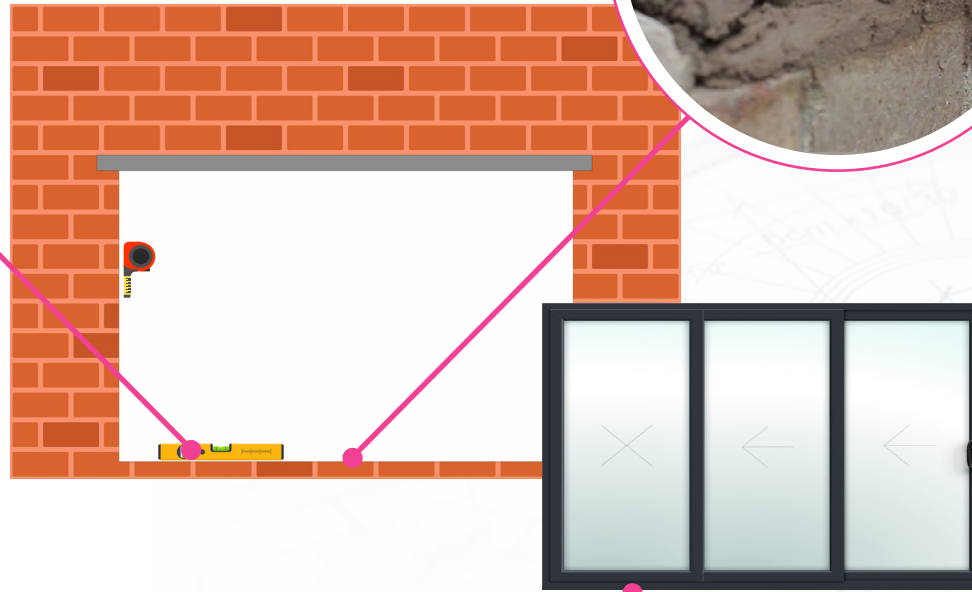

STEP 3 Fit the optional Cill to the outerframe of the sliding door.

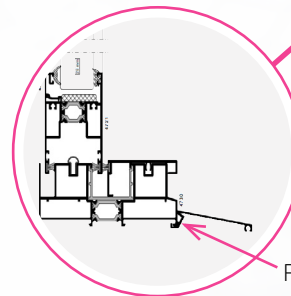

Fix here.



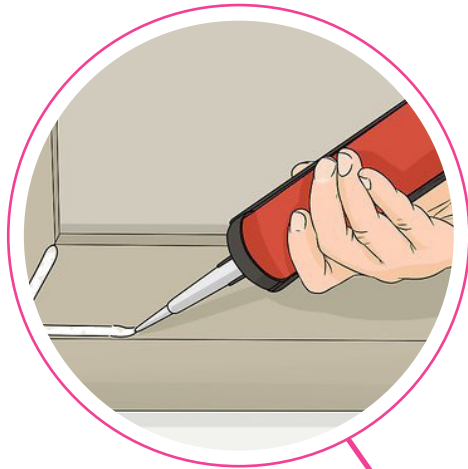

STEP 4 Run a bead of silicone along the outer edges of each side of the prepared area ready for the sliding doors to bed on to.



STEP 6 To hold the door in place temporarily whilst you level it, loosely pack out the jambs. Keep checking they are level as you go along, as this will help to avoid any potential issues in later steps.

There should be no twist or distortion in the jambs & they should be plumb.

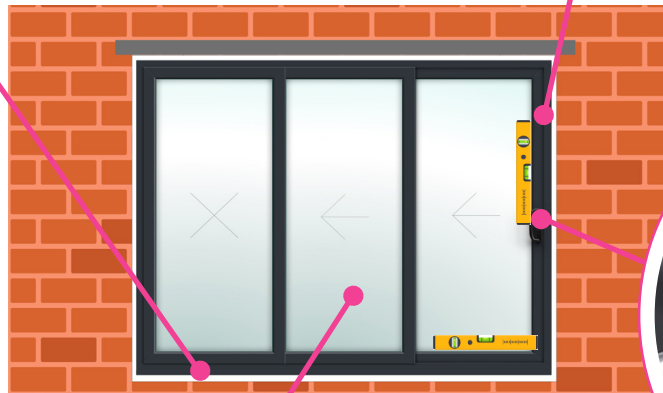

STEP 7 With the packers in place, fix both outer jambs in place with appropriate fixings.

Fixings should be no closer than 150mm from corners & at 600mm maximum centres, with a minimum of 3 fixings per side.

A shield must be used to prevent damage from drills & screwdrivers.

STEP 5 Lift the sliding door into position in the opening. Hold the door in place temporarily whilst you level it,.



- Packers must be used at either side of each fixing to help prevent distortion. Continue to check for any bows, as well as for plumbness & squareness.



STEP 8 Align the threshold against the cill & fix into place. Use appropriate fixings to secure down through the channel of the outer frame. Use silicone in conjunction with each fixing.

- Make sure the screws are fully fixed so that they do not interfere with the refitting of the threshold cover.



STEP 10 Before glazing, remove all beads from the sliding sash, taking care to note where the beads are removed from.

Fit the glazing packers in preparation for glazing.

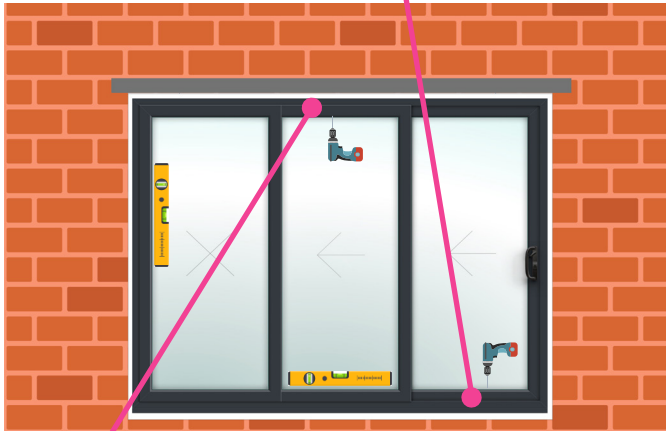
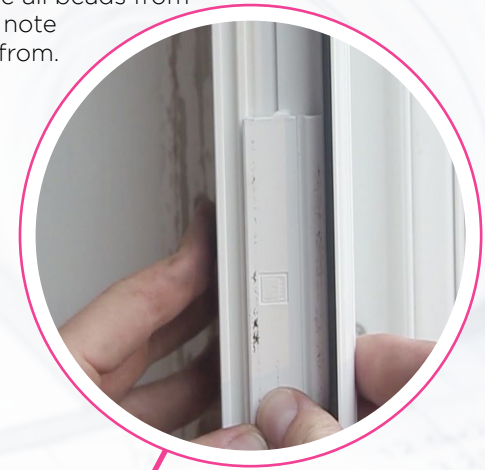

STEP 9 Pack the head parallel to the cill. A timber lat can be used to help ensure it is parallel.

Fix the head into place, completing the outer frame installation. Perform a final check of the doors level, plumb & squareness again.

Cover the top of any fixings in the cill with silicone to avoid any water ingress.

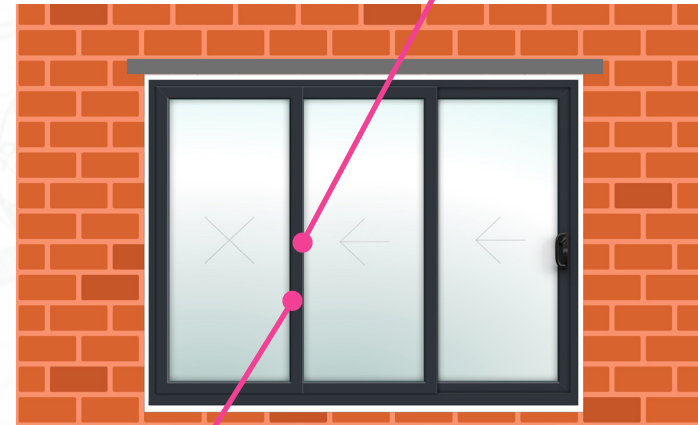

STEP 11 Add silicone between each vertical packer set to help keep them in place & ensure that all packers do not obstruct any drainage holes.



STEP 12 Fit the glass onto the glazing packers from the inside, & pack it appropriately.

L - load bearing platforms must be used to keep door square & level.

B - Bracing platforms to prevent movement & provide rigidity to the door



STEP 13 Once the glass is in place, the beading can be replaced, starting with the shortest piece first. Use a plastic mallet to tap each piece into place. We recommend starting in the corners, & working towards the middle.

Fit the gasket, ensuring it isn't stretched and is cut oversize by 10mm per meter. Remember to force into the corners first and then loop from the centre towards the corners.

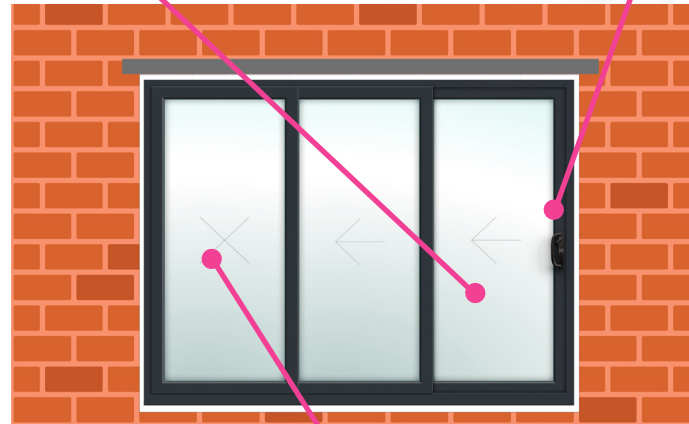
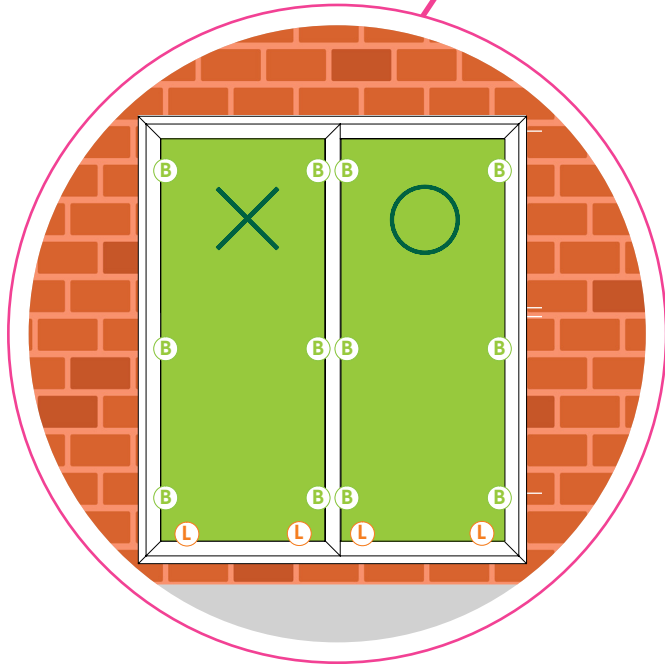

STEP 14 Repeat the glazing process for the fixed sash/es.





STEP 15 Check the finished doors to make sure the operation is perfect. The rolling mechanism should be smooth, & all the seals should be weather tight.



STEP 17 Ensure all dust & grit is removed from the external surfaces then apply a strip of masking tape to the frame perimeter. Apply a smooth bead of silicone sealant between the frame & brickwork. Remove the masking tape before the sealant sets for a neat, clean finish.

- Don't forget to seal below the external cill.

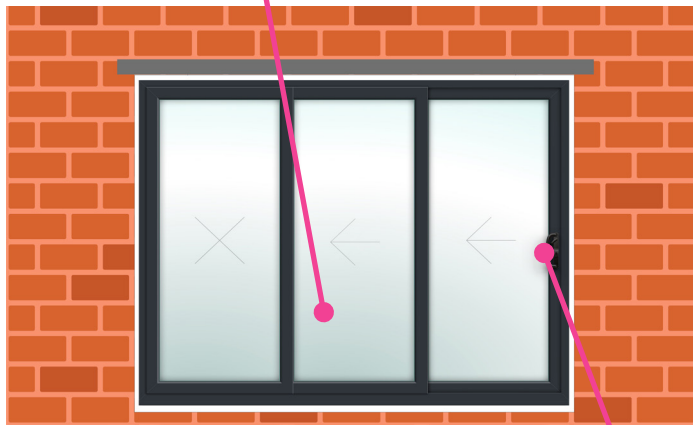

STEP 16 Make any final adjustments as necessary.

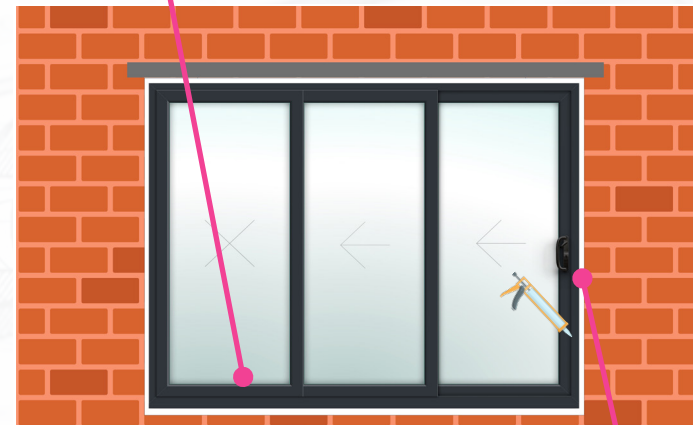

STEP 18 Remove any protective films from the sliding door.

Make good the internal reveals.



STEP 19 Final checks.

Check that the handles & locking mechanisms operate smoothly. Check the action is smooth & free running. Check that the locks operate correctly when closed.

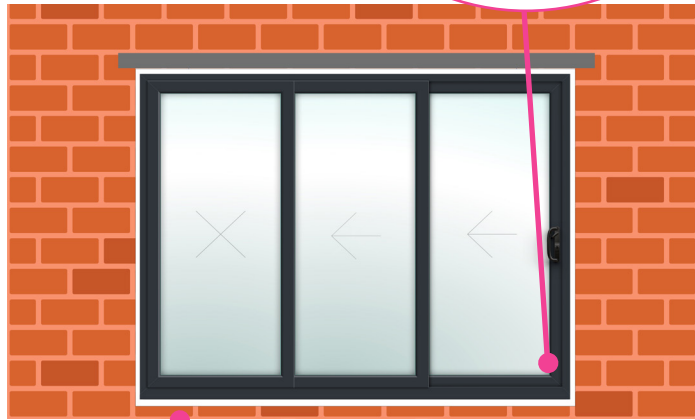

STEP 20 The rolling mechanism won't work smoothly if there is any debris in the door track, so make sure you clean it properly with a soft brush.

STEP 21 The installation is now complete.....

STEP 22 Get the kettle on!

Product specification is subject to change without notification.

Please note that colours shown are for illustrative purposes only.

Whilst every effort is taken to avoid errors, PBSL Group cannot accept responsibility for the accuracy of any statement, extract or information contained within this guide.

PBSL Group may change or update this guide without prior notice.



**ALSO AVAILABLE
FROM**

**BIFOLD
SALES**

PART OF THE PBSL GROUP



uPVC French Doors are a great choice if you are looking to maximise the amount of natural light in your home and unify your indoor space with your outdoor space. With large glass panelling and high-quality uPVC frames, these double-glazed French Doors will give a traditional and classic look to any property.



Aluminium bifold doors are a great addition to a property. With a clean, modern appearance and great thermal efficiency, aluminium bifolds can maximise the light that enters your home and unify your indoor and outdoor spaces.



At Bifold Sales we supply a range of aluminium sliding doors, created with innovative technology and engineering to result in a modern appearance and slim sightlines.



uPVC bifold doors boast a multi-panelled door design that folds smoothly away to free up 90% of the entrance aperture. Providing a contemporary finish that is sure to modernise your home, these bifold patio doors will allow you to experience unrivalled levels of accessibility and space.



As one of the world's fastest-growing suppliers of roof windows, Fakro roof windows combine utility, energy efficiency, and security without sacrificing aesthetic, and we're proud to be able to supply such high-quality products at Bifold Sales.



Whether you are searching for a brand-new patio door to improve access to your garden, or you require a new replacement inside door, you will be surprised how distinctive our new uPVC sliding door line is compared to other sliding doors on the market.



FAKRO flat roof window frames are constructed by using a reinforced multi-chamber PVC profile. The materials are resistant to acids and have a low moisture absorption rate, making them suitable for installation in any room.